

Vertical Section
Scale: 1:50

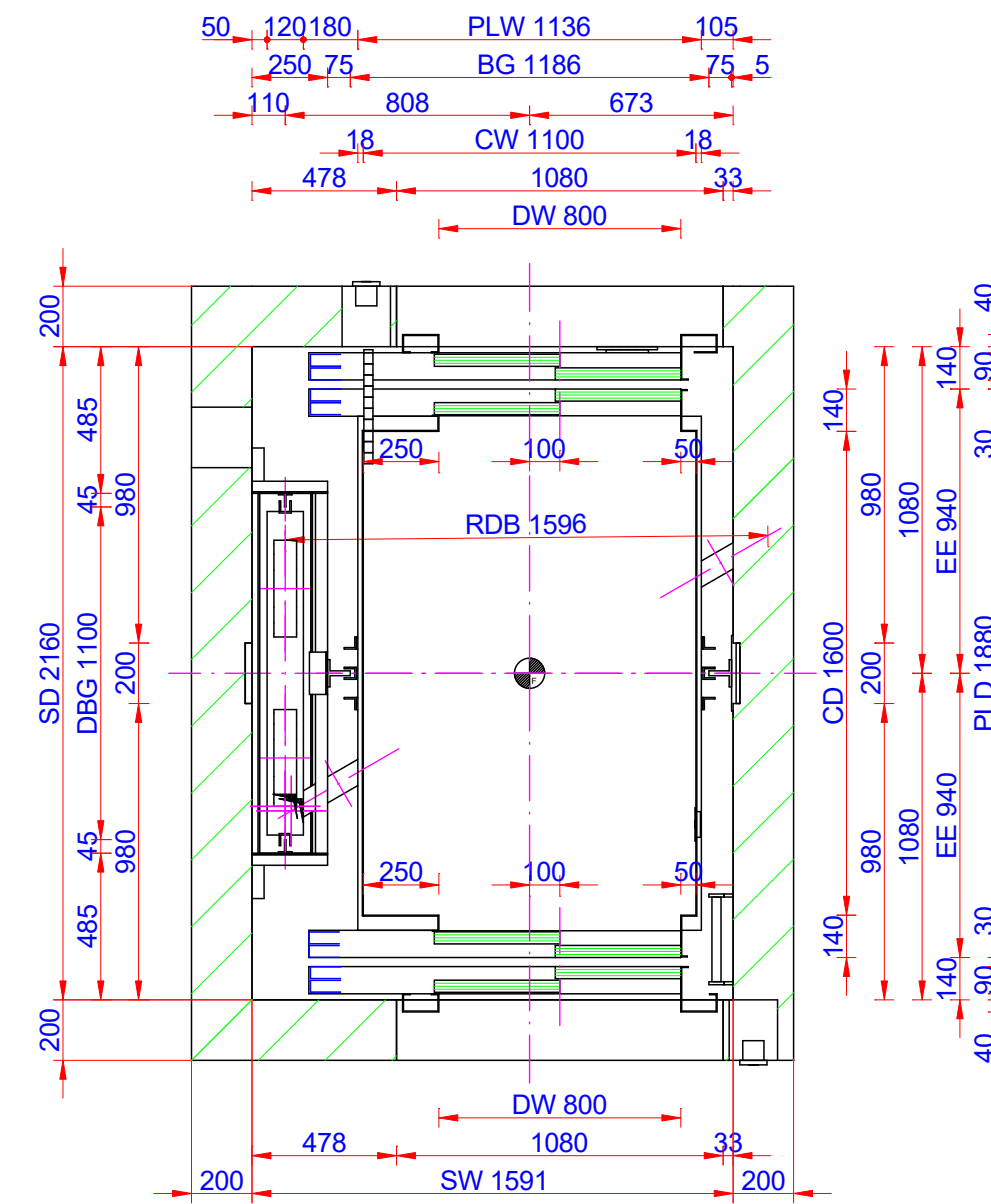

Plan View
Scale: 1:25

Nominal load (kg): 750 Travel (mm): 20400		Speed (m/s): 1 Car: 1100 x 1600	Stops (n°): 7 Doors: 800 x 2000
drawn: B.Moradi	Project No.:	YARAN ELEVATOR MR .Mmohamadnejad	
verified:	007.403		
approved:	DWG-No.: 01		
Date: 8/18/2024		Phone: 9821-88 62 45 49 Fax:	Units of dims.: [mm]
		LD A3 Assembly Drawing/0	

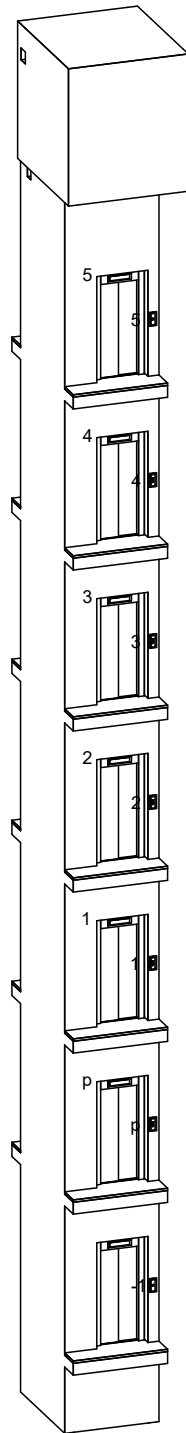

Nominal load (kg): 750
 Travel (mm): 20400

Speed (m/s): 1
 Car: 1100 x 1600

Stops (n°): 7
 Doors: 800 x 2000

drawn: B.Moradi

Project No.:

verified:

007.403

approved:

DWG-No.: 01

YARAN ELEVATOR

MR .Mmohamadnejad

Phone: 9821-88 62 45 49 Fax:

Date: 8/18/2024

LD A4 3D View/0

Units of dims.: [mm]

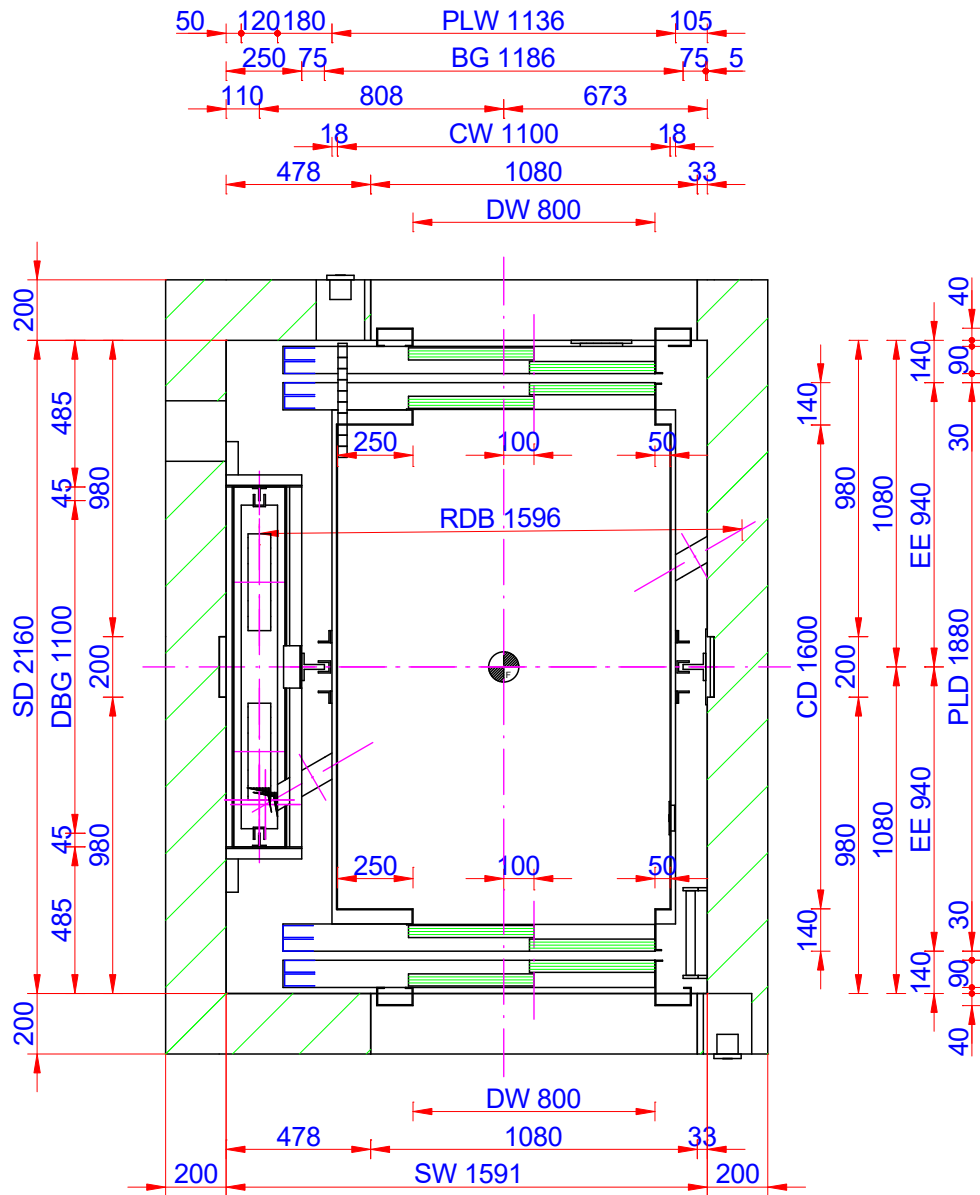

Plan View

Scale: 1:25

Nominal load (kg): 750
Travel (mm): 20400

Speed (m/s): 1
Car: 1100 x 1600

Stops (n°): 7
Doors: 800 x 2000

drawn: B.Moradi	Project No.:
verified:	007.403
approved:	DWG-No.: 01

YARAN ELEVATOR

MR .Mmohamadnejad

Phone: 9821-88 62 45 49 Fax:

Date: 8/18/2024

LD A4 Plan Drawing/0

Units of dims.: [mm]

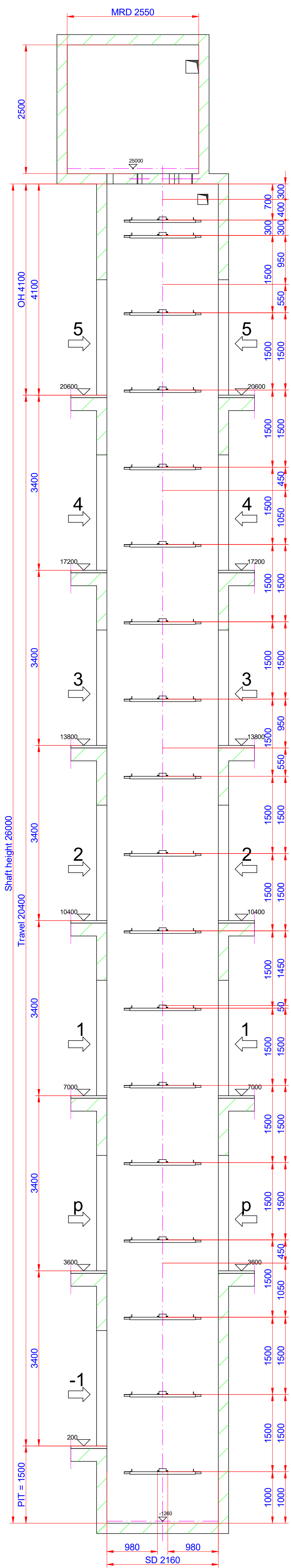

Vertical Section
Scale: 1:50

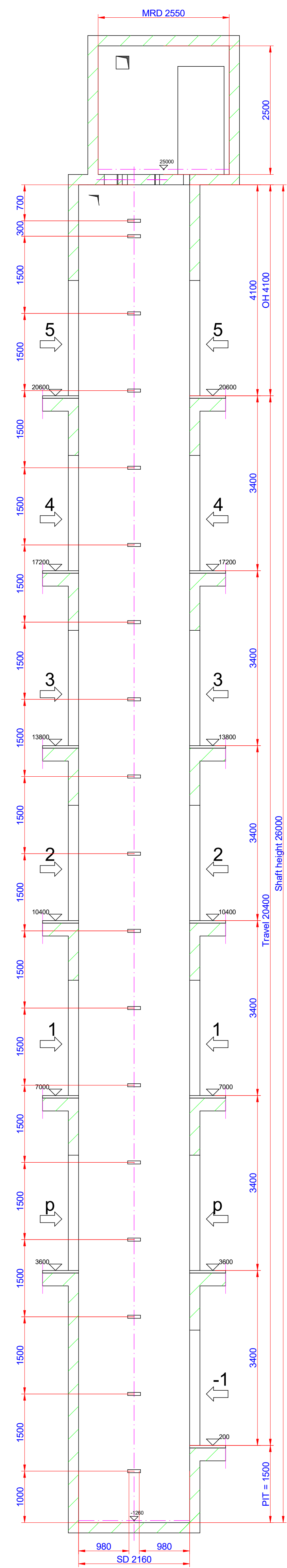

Vertical Section
Scale: 1:50

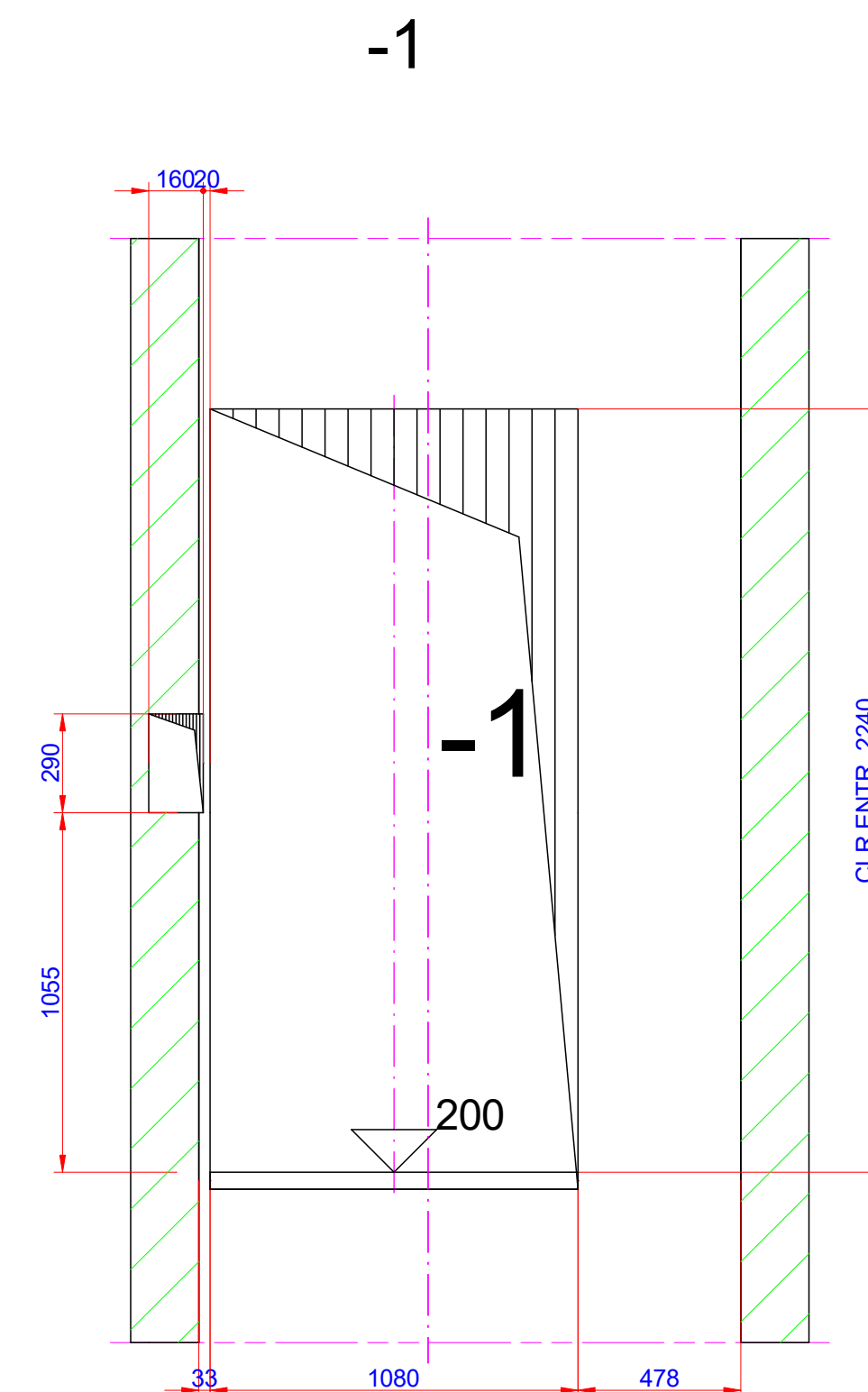

Entrance front
Detail inside
Scale: 1:20

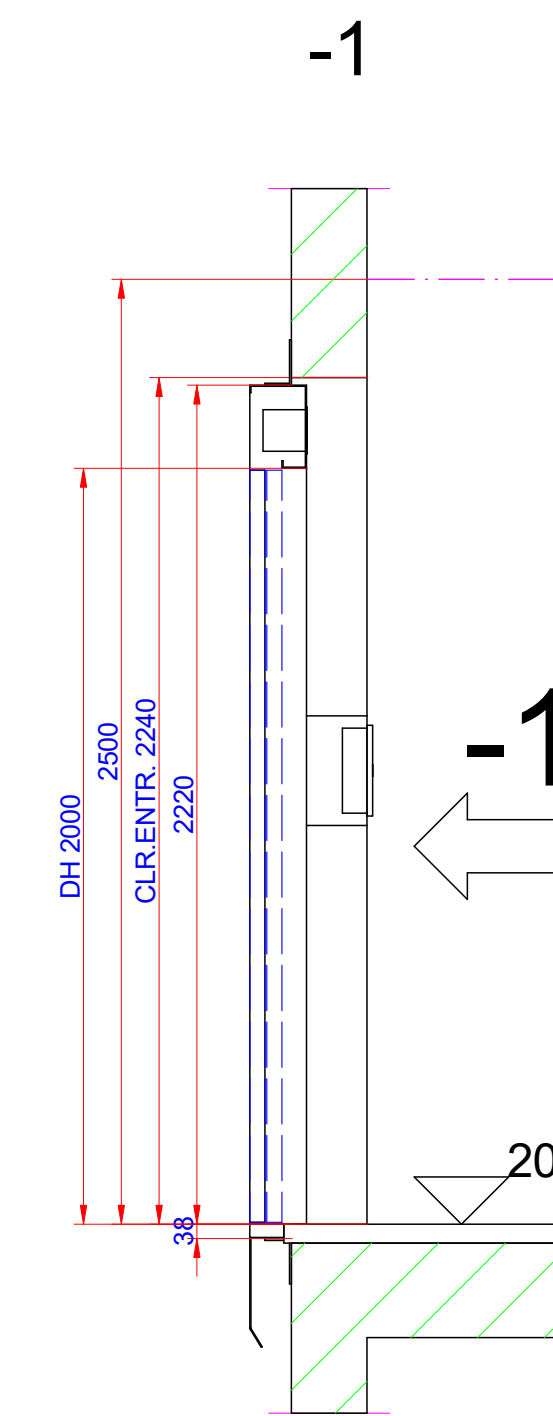

Entrance front
Detail side
Scale: 1:20

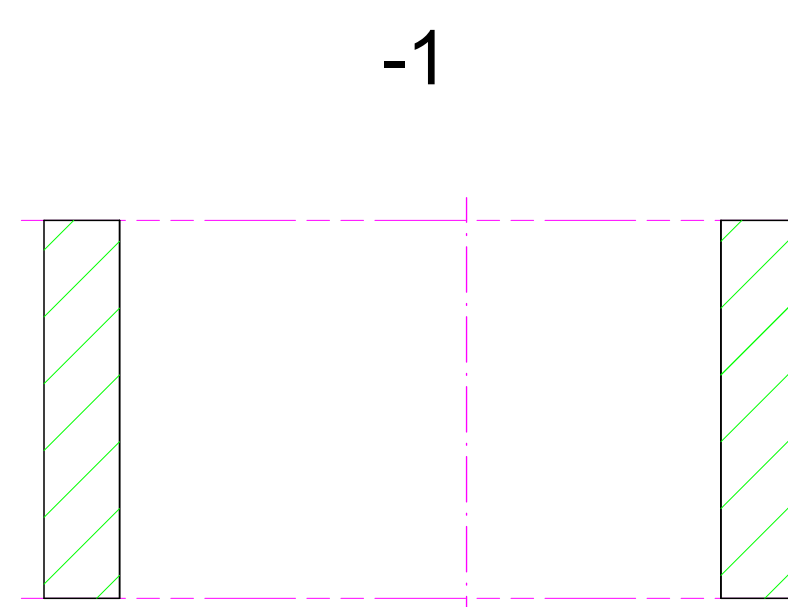

Entrance rear
Detail inside
Scale: 1:20

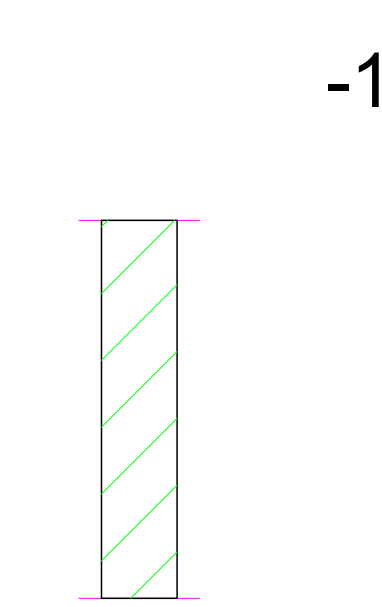

Entrance rear
Detail side
Scale: 1:20

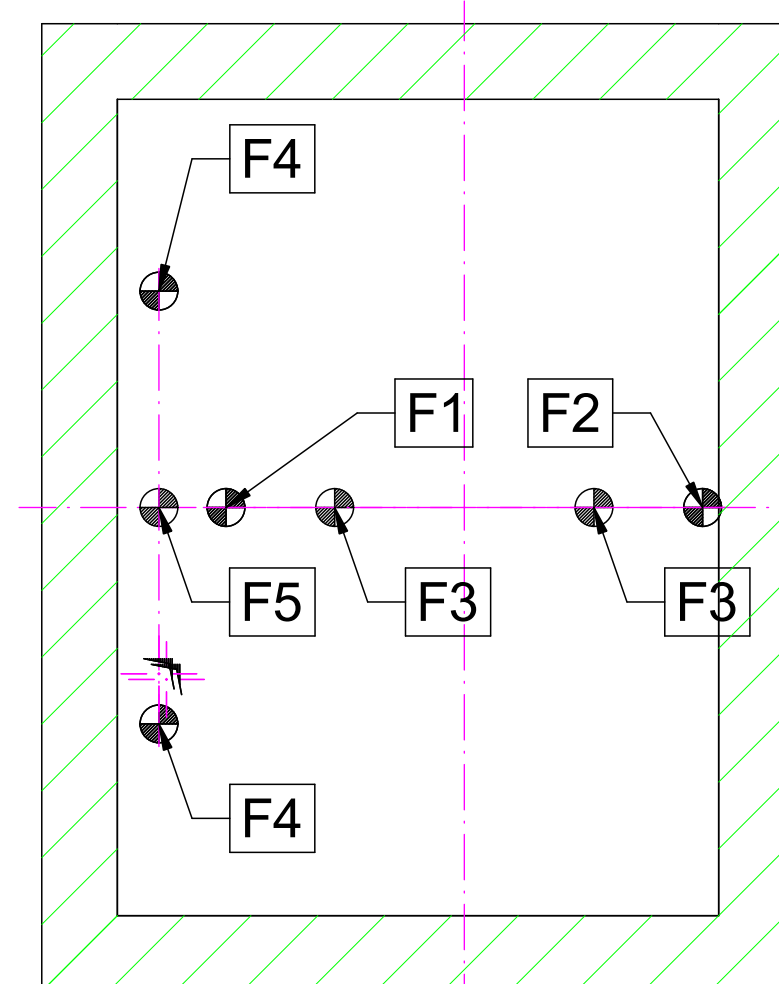

Pit Forces
Scale: 1:20

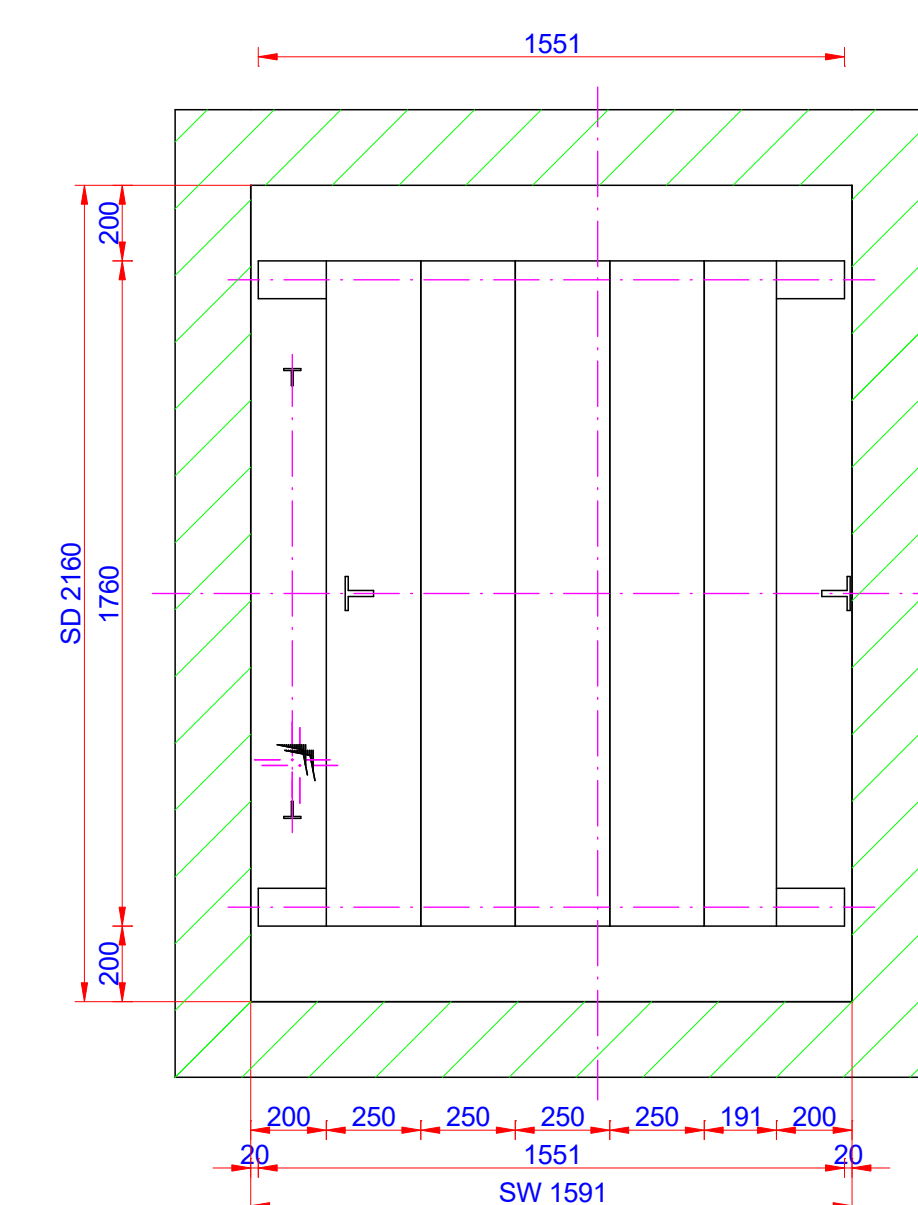

Scaffolding Plan
Scale: 1:20

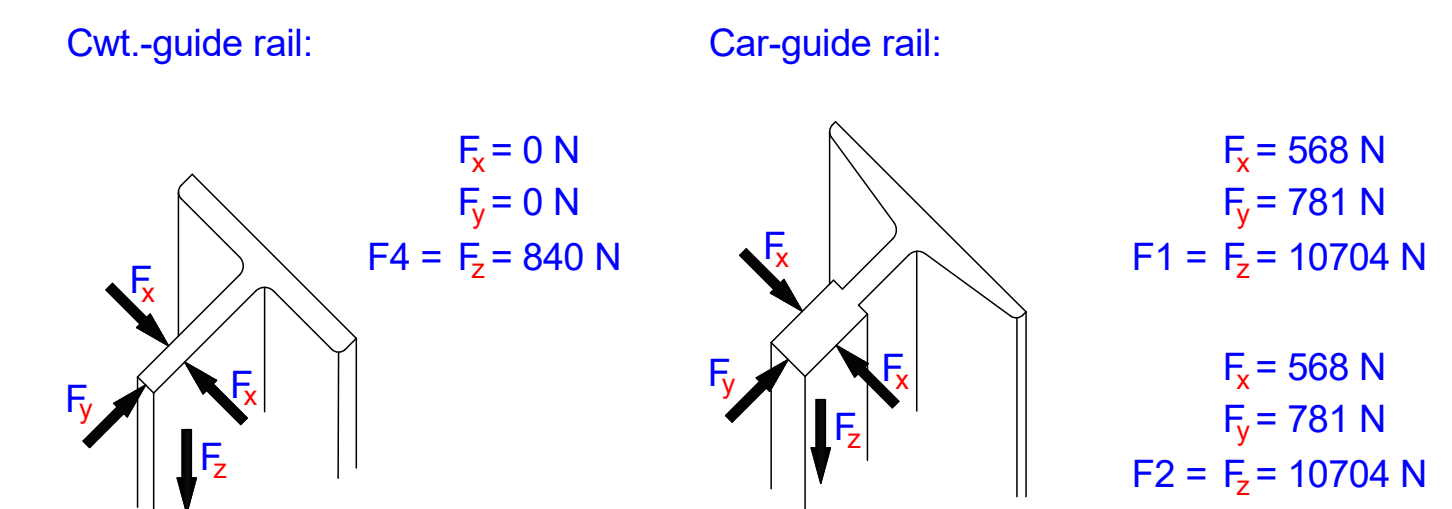

Forces (N) for :

F1: 10704	F6: 0	F10: 0	F20: 0
F2: 10704	F7: 0	F11: 0	F21: 0
F3: 29430	F8: 0	F12: 0	
F4: 840	F9: 0	F13: 0	
F5: 14715		F14: 0	
		F15: 0	

- EN 81

Drive: 2-1
Nominal load (kg): 750 - 10 Passengers
Travel (mm): 20400
Speed (m/s): 1

Stops (n°): 7	Traction sheave: 450	Machine model: Standard drive unit
Entrances: 7+6+0+0	Rope(s): Rope Ø 12 x 5	Performance: 10 kW
Doors: 800 x 2000	Car-guide rail: 90 x 75 x 16	I ₁ : I ₂ : R ₁ :
Car: A = 1.84 m ²	Cwt-guide rail: 45 x 45 x 5	Governor: Governor
CW = 1100 mm	Buffer: Spring buffer	
CD = 1600 mm	Cwt-buffer: Spring buffer	Control unit:
CH = 2000 mm		

Project: mohamad nejad

Owner:

Architect:

Phone: Fax:

Site supervision:

Phone: Fax:

Drawn: B.Moradi
verified: 007_403
Date: DWG-No.: 01

Project No.:
007_403
Date: DWG-No.: 01

YARAN ELEVATOR
MR_Mmohamadnejad

Phone: 9821.88.62.45.49 Fax:
LD Builders Drawing©

Date: 8/18/2024

Units of dims.: [mm]

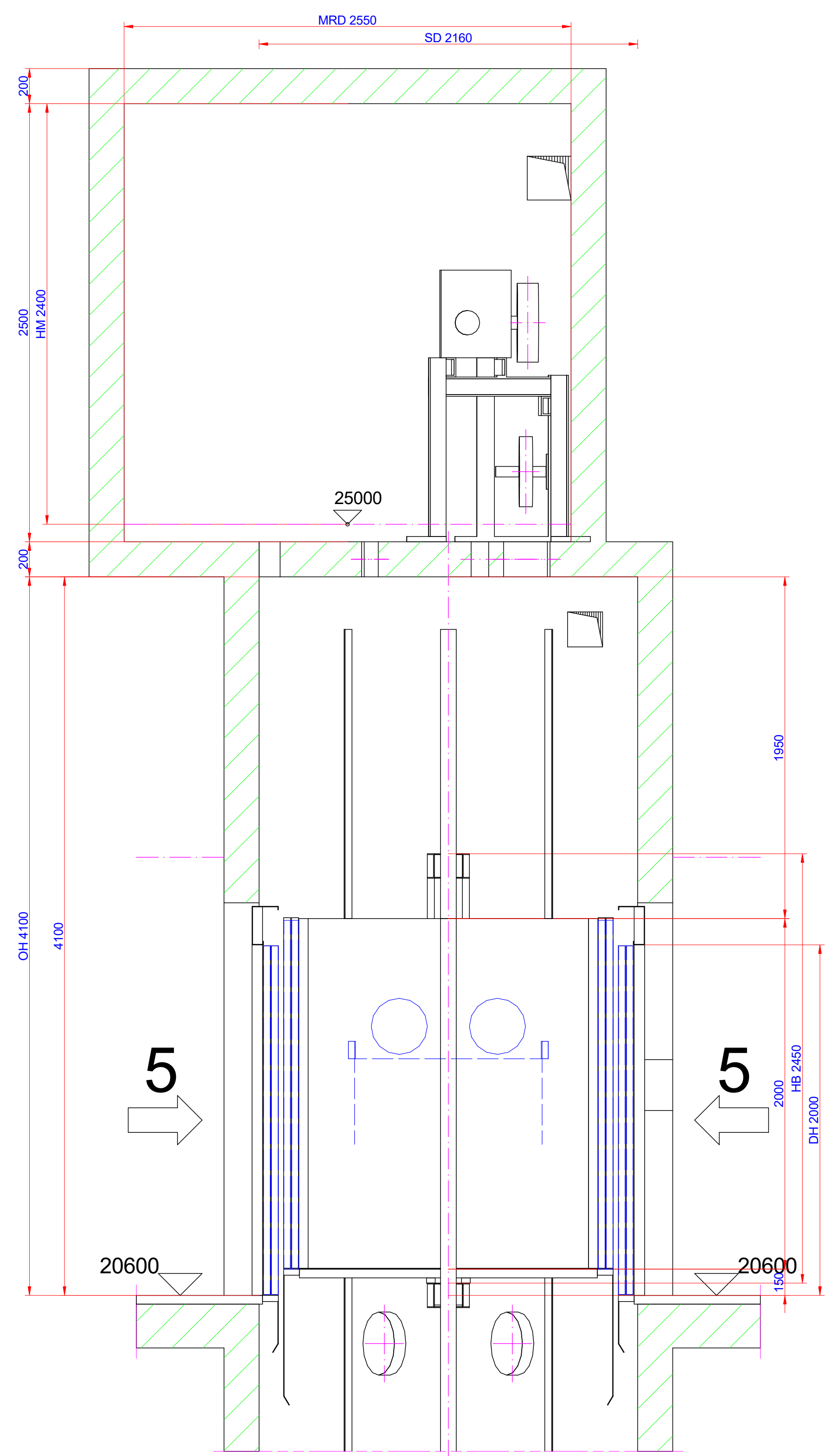

Cross Section Overhead
Scale: 1:20

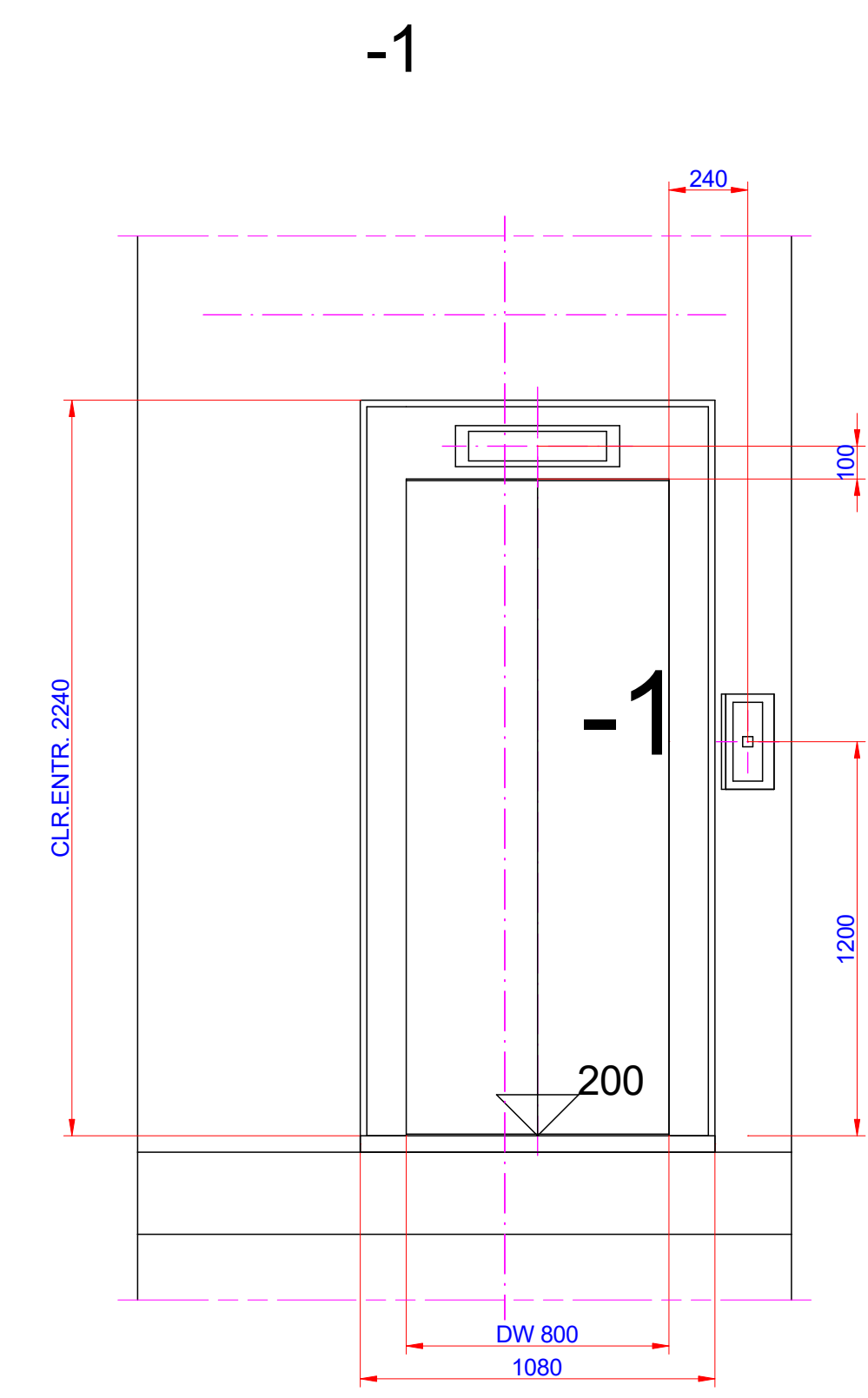

Entrance front
Detail outside
Scale: 1:20

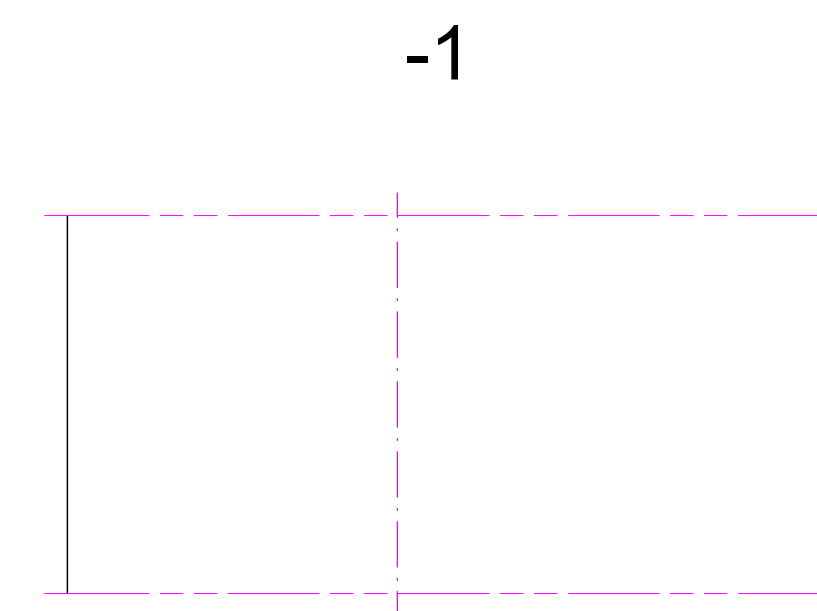

Entrance rear
Detail outside
Scale: 1:20

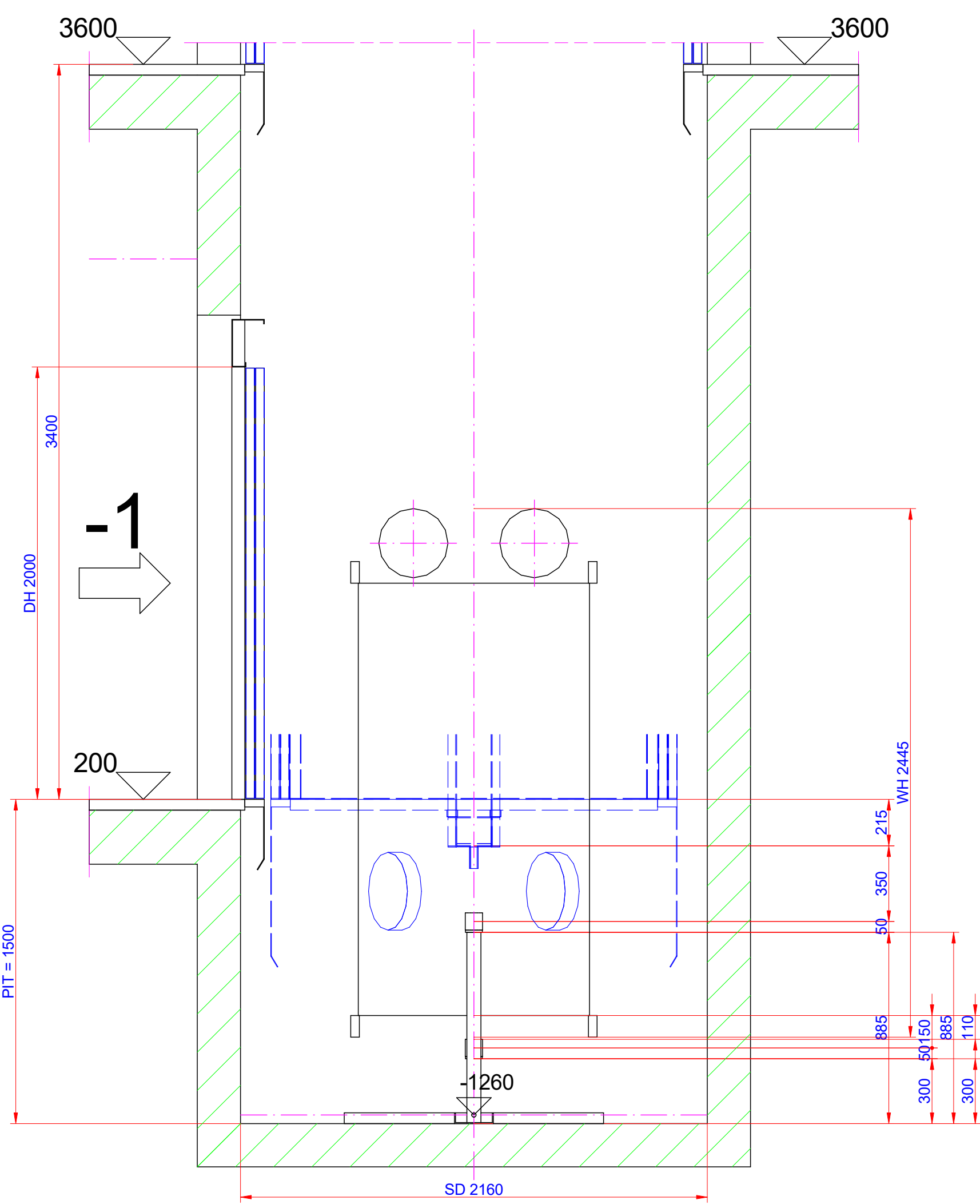

Cross Section Pit
Scale: 1:20

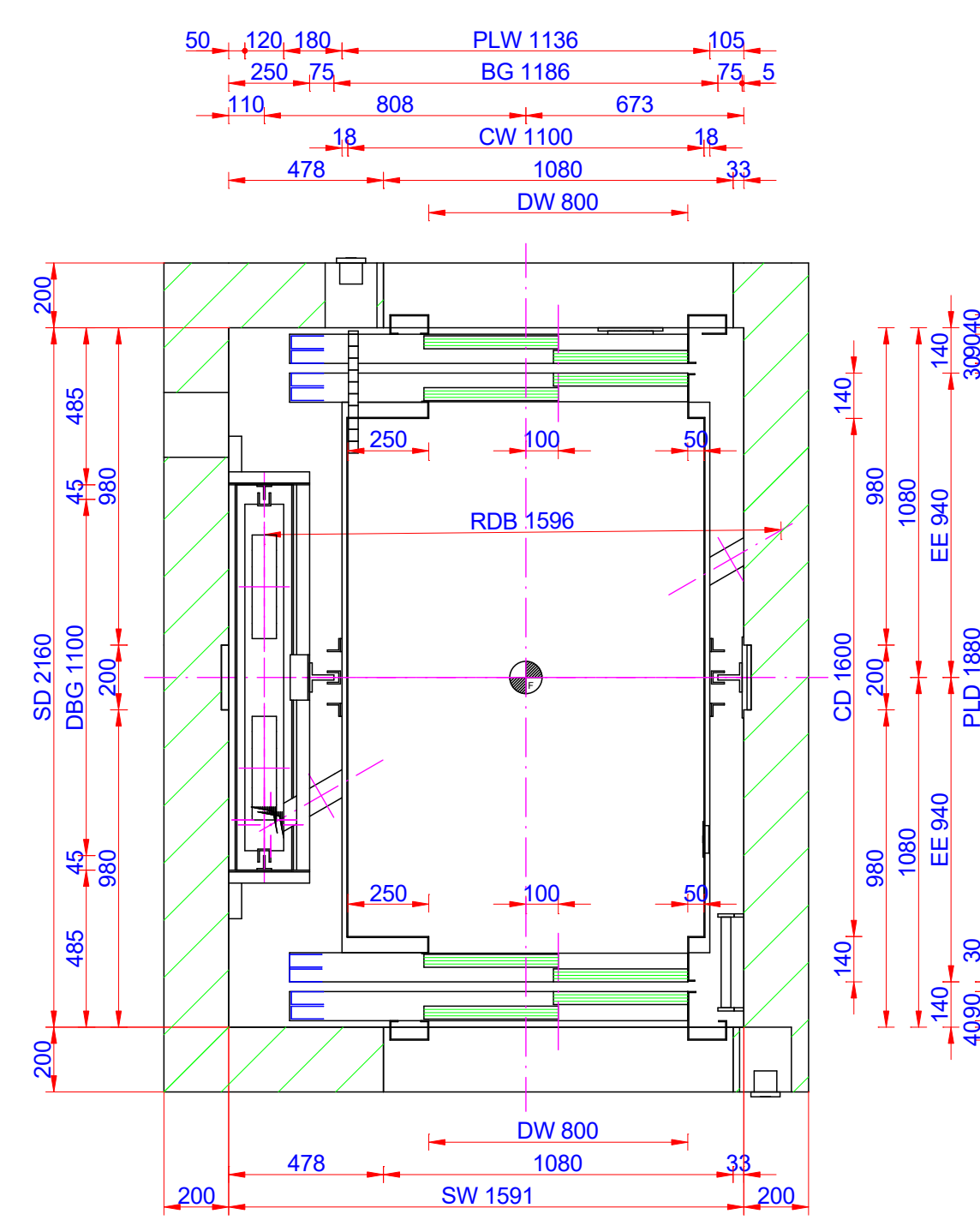

Plan View
Scale: 1:20

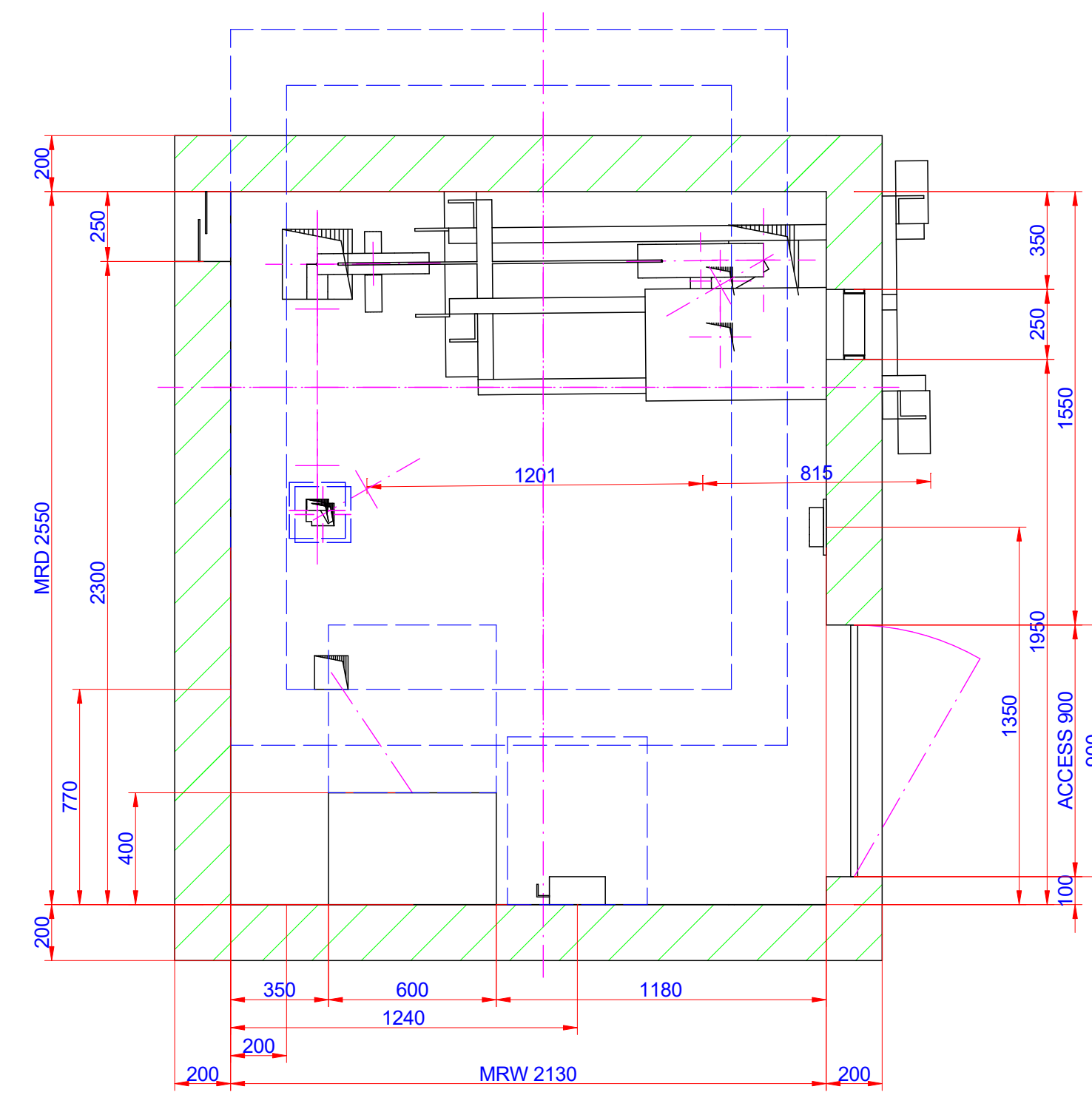

Machine Room
Scale: 1:20

Forces (N) for :

F1: 10704	F6: 0	F10: 0	F20: 0
F2: 10704	F7: 0	F11: 0	F21: 0
F3: 29430	F8: 0	F12: 0	
F4: 840	F9: 0	F13: 0	
F5: 14715		F14: 0	
		F15: 0	

- EN 81

Drive: 2-1
Nominal load (kg): 750 - 10 Passengers
Travel (mm): 20400
Speed (m/s): 1

Stops (n°): 7	Traction sheave: 450	Machine model: Standard drive unit
Entrances: 7+0+0+0	Rope(s): Rope Ø 12 x 5	Performance: 10 kW
Doors: 800 x 2000	Car-guide rail: 90 x 75 x 16	l _c : l _c : R:
Car: A = 1.84 m ²	Cwt.-guide rail: 45 x 45 x 5	Governor: Governor
CW = 1100 mm	Buffer: Spring buffer	
CD = 1600 mm	Cwt.-buffer: Spring buffer	Control unit:
CH = 2000 mm		

Project: mohamad nejad

Owner:

Architect:

Phone: Fax:

Site supervision:

Phone: Fax:

Drawn: B.Moradi Project No.:
verified: 007.403
Date: DWG-No.: 01

YARAN ELEVATOR
MR_Mmohamadnejad

Phone: 9821-88 82 45 49 Fax:
LD Installation Drawing/0 Units of dims.: [mm]

Date: 8/18/2024